

Signature: G. Harman  
G. Harman (Apr 6, 2023 12:24 GMT+1)  
Email: glenn.harman@ioconsulting.com  
Title: CSA Designer  
Company: io Consulting (Energy) UK LLP

Signature: H. Yassaei  
H. Yassaei (Apr 6, 2023 12:27 GMT+1)  
Email: hassan.yassaei@iooilandgas.com  
Title: CSA Lead Engineer  
Company: io consulting (energy) UK LLP

Signature: Fergus Herbert  
Fergus Herbert (Apr 6, 2023 12:27 GMT+1)  
Email: Fergus.Herbert@ioconsulting.com  
Title: Director of Engineering  
Company: io consulting (energy) UK LLP

A1P2V

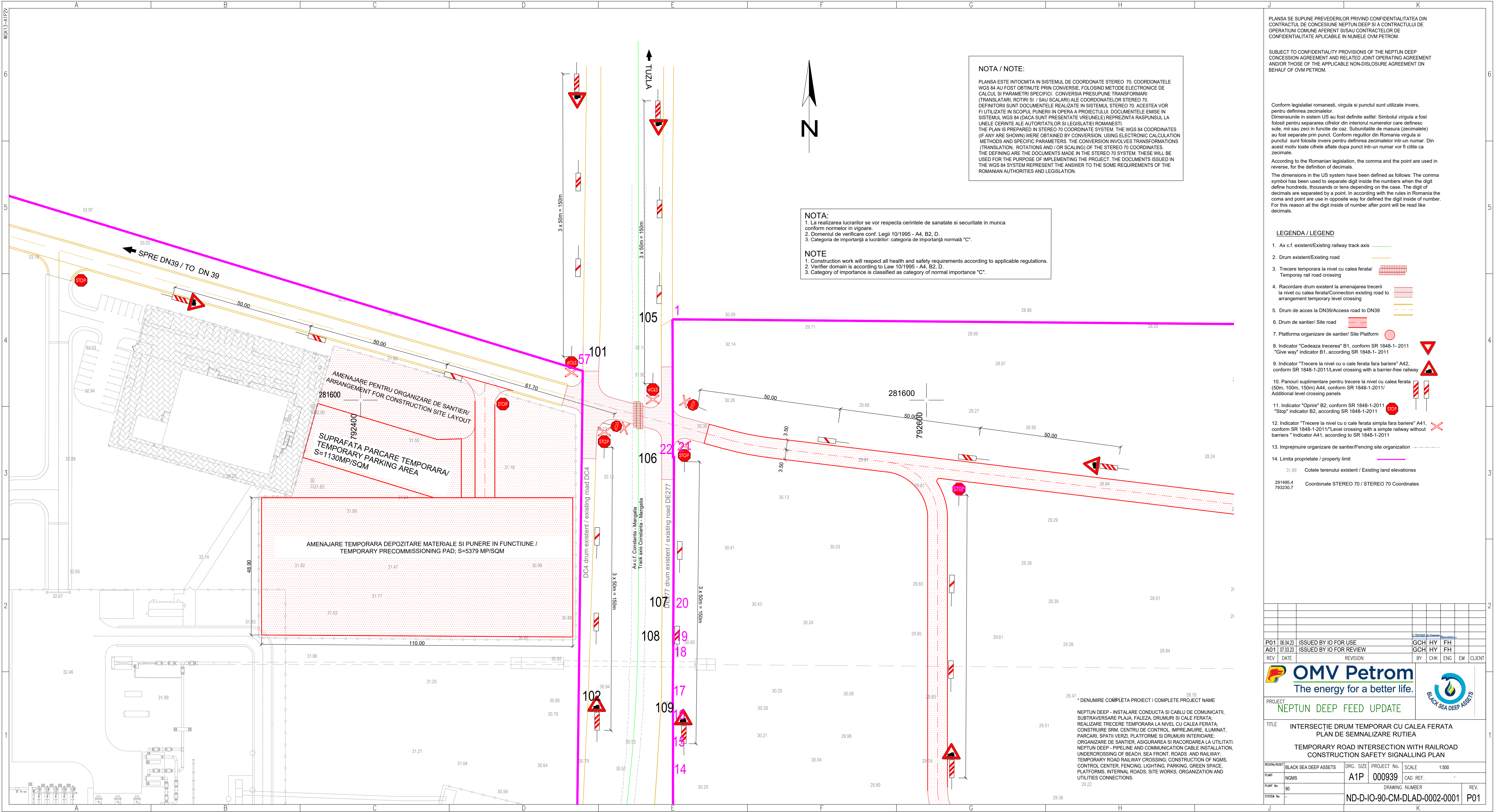

PLANSĂ SE SUPLINE PREVEDERILOR PRIVIND CONFIDENTIALITATEA DIN  
CONTRACTUL DE CONCESIUNE NEPTUN DEEP SI A CONTRACTULUI DE  
OPERATIUNI COMUNE AFERENT SISAU CONTRACTULOR DE  
CONFIDENTIALITATE APLICABILE IN NUMELE OVM PETROM.

SUBJECT TO CONFIDENTIALITY PROVISIONS OF THE NEPTUN DEEP  
CONCESSION AGREEMENT AND RELATED JOINT OPERATING AGREEMENT  
AND/OR THOSE OF THE APPLICABLE NON-DISLOSURE AGREEMENT ON  
BEHALF OF OVM PETROM.

Conform legislatiei romanesti, virgula si punctul sunt utilizate invers,  
pentru definirea zecimalilor.  
Dimensiunile in sistem US au fost definite astfel: Simbolul virgula a fost  
folosit pentru separarea cifrelor din interiorul numerelor care definesc  
sute, mii sau zeci in functie de caz. Subunitatile de masura (zecimalele)  
au fost separate prin punct. Conform regulilor din Romania virgula si  
punctul sunt folosite invers pentru definirea zecimalilor intr-un numar. Din  
acest motiv toate cifrele aflate dupa punct intr-un numar vor fi citite ca  
zecimale.

According to the Romanian legislation, the comma and the point are used in  
reverse, for the definition of decimals.  
The dimensions in the US system have been defined as follows: The comma  
symbol has been used to separate digits inside the numbers when the digit  
define hundreds, thousands or tens depending on the case. The digit of  
decimals are separated by a point. In accordance with the rules in Romania the  
comma and point are used in opposite way for defined the digit inside of number.  
For this reason all the digit inside of number after point will be read like  
decimals.

- LEGENDA / LEGEND**
- Ax c.f. existent/Existing railway track axis
  - Drum existent/Existing road
  - Trecere temporara la nivel cu calea ferata/  
Temporary rail road crossing
  - Racordare drum existent la amenajarea trecerii  
la nivel cu calea ferata/Connection existing road to  
arrangement temporary level crossing
  - Drum de acces la DN39/Access road to DN39
  - Drum de santier/ Site road
  - Platforma organizare de santier/ Site Platform
  - Indicator "Cedeaza trecerea" B1, conform SR 1848-1- 2011  
"Give way" indicator B1, according SR 1848-1- 2011
  - Indicator "Trecere la nivel cu o cale ferata fara bariere" A42,  
conform SR 1848-1-2011/Level crossing with a barrier-free railway
  - Panouri suplimentare pentru trecere la nivel cu calea ferata  
(50m, 100m, 150m) A44, conform SR 1848-1-2011/  
Additional level crossing panels
  - Indicator "Oprite" B2, conform SR 1848-1-2011  
"Stop" indicator B2, according SR 1848-1-2011
  - Indicator "Trecere la nivel cu o cale ferata simpla fara bariere" A41,  
conform SR 1848-1-2011/Level crossing with a simple railway without  
barriers " Indicator A41, according to SR 1848-1-2011
  - Imprejmuire organizare de santier/Fencing site organization
  - Limita proprietate / property limit
- 31.89 Cotele terenului existent / Existing land elevations  
291486.4  
793250.7 Coordonate STEREO 70 / STEREO 70 Coordinates

P01	06.04.23	ISSUED BY IO FOR USE	GCH	HY	FH
A01	07.03.23	ISSUED BY IO FOR REVIEW	GCH	HY	FH
REV	DATE	REVISION	BY	CHK	ENG

**OMV Petrom**  
The energy for a better life.

PROJECT  
NEPTUN DEEP FEED UPDATE

TITLE  
INTERSECȚIE DRUM TEMPORAR CU CALEA FERATA  
PLAN DE SEMNALIZARE RUTIEA  
TEMPORARY ROAD INTERSECTION WITH RAILROAD  
CONSTRUCTION SAFETY SIGNALLING PLAN

REGION/ASSET	BLACK SEA DEEP ASSETS	DRG. SIZE	PROJECT No.	SCALE	1:500
PLANT	NGMS	A1P	000939	CAD REF.	
PLANT No.	90			DRAWING NUMBER	
SYSTEM No.	-			ND-D-IO-90-CM-DLAD-0002-0001	P01